



Portsea 22 (Lot 2335)

4 2 2

252m² | 22.22sq

Clyde North
Lot 2335, Chiffon Grove

Inclusions

House and Land Package includes:

Turn key inclusions

25 Year Structural Guarantee

2590mm high ceilings to main living

LED Downlights to main living areas as per plan

20mm mineral surface benchtops to the kitchen, bathroom and ensuite

Fisher & Paykel appliances

Split system to main living area

Letterbox

Low maintenance landscaping

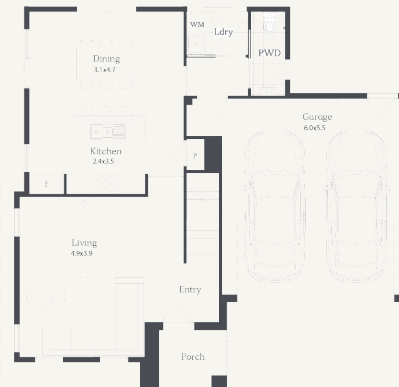
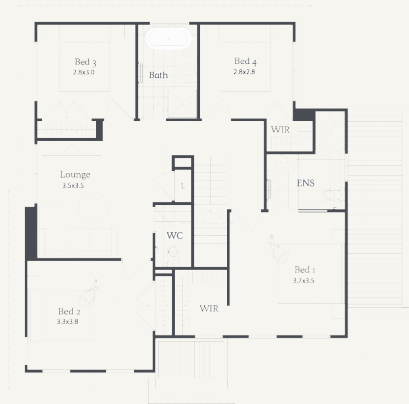

For more information please contact Ethan Playnsek on 0484 279 605

Architectural designs, built with purpose

Images are artists impression only and may include items not supplied by Nostra Homes. Please refer to project inclusions list for full specifications.